

JEILMEDICAL

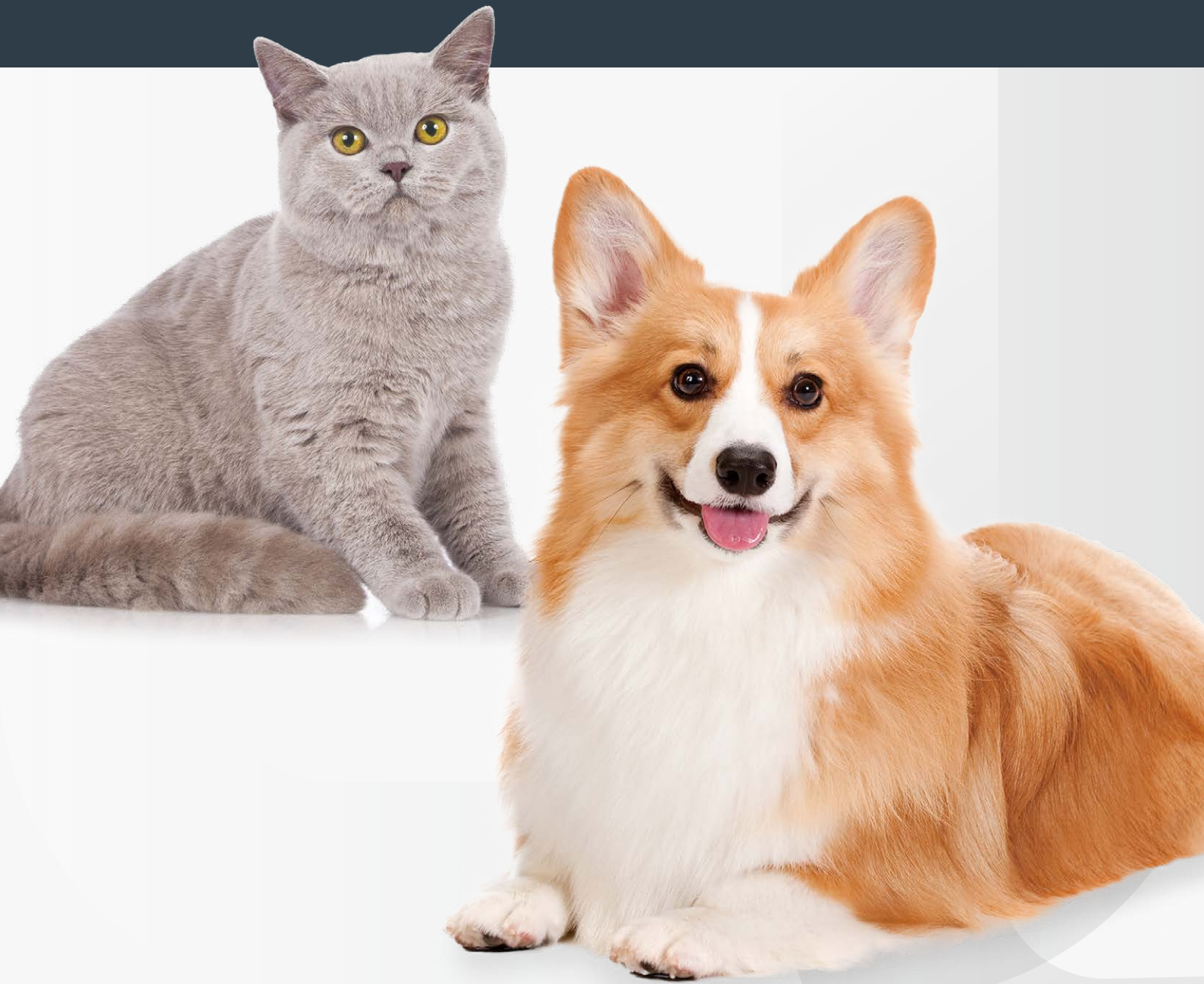

1.2 / 1.5 / 2.0 mm System



# Contents

4	Features & Benefits
	Ordering Information
6	- Plates
12	- Screws
14	- Instruments
21	Set Configuration Suggestion



1.2 / 1.5 / 2.0 mm System

Standard Osteosynthesis for Small Pets

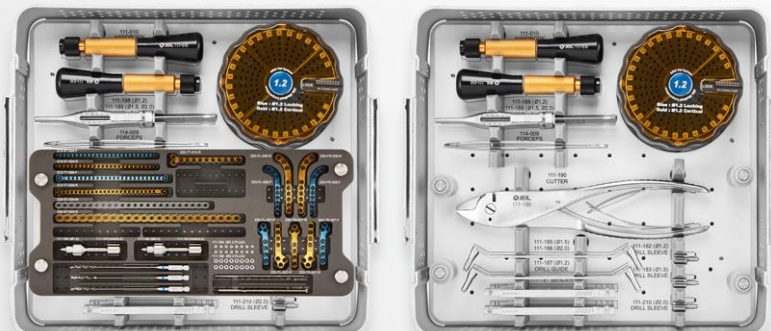
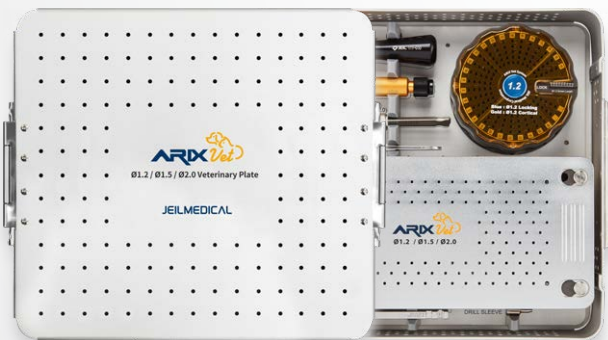

## General Features

- Anatomically pre-contoured
- Material: Titanium Alloy
- Left & right plate variation for anatomical fitting
- Limited contact design for better blood supply
- Variable locking system up to  $\pm 15^\circ$
- Plate thickness 1.4 ~ 2.5 mm
- Both Rigid (Gold) and Flexible (Blue) types available
- Disposable battery power driver available (optional)
- Various plate shapes

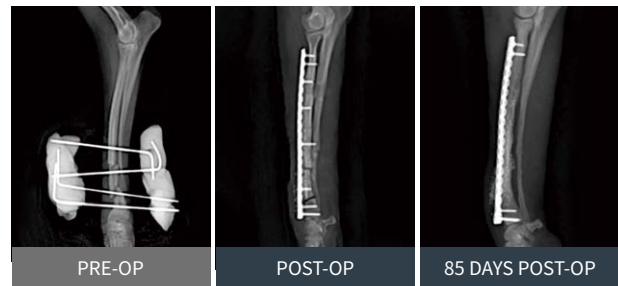

## Plates



Straight Plate

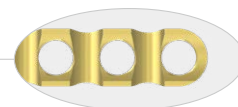

Limited Contact Design

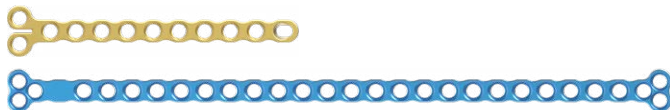

T-Plate



CBLO Plate

DFO Plate

TPLO Plate

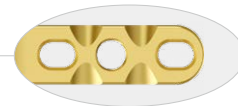

Limited Contact Design



Bridge Plates



Acetabulum Plate

## Plate Specifications

Types	Size		Thickness	Color	Material
Straight Plate	Z12	Flexible	1.4 mm	Blue ●	Titanium Alloy
		Rigid	1.7 mm	Gold ●	
	Z20	Middle	2.0 mm	Silver ●	
		Rigid	2.2 mm	Gold ●	
T Plate	Z12	Flexible	1.4 mm	Blue ●	
	Z20	Rigid	1.7 mm	Gold ●	
TPLO Plate	Z20	Flexible	2.0 mm	Blue ●	
		Rigid	2.0 mm	Gold ●	
DFO Plate	Z20	Flexible	2.0 mm	Blue ●	
		Rigid	2.0 mm	Gold ●	
CBLO Plate	Z20	Rigid	2.5 mm	Gold ●	
Acetabulum Plate	Z20	Rigid	2.0 mm	Gold ●	
Bridge Plate	Z20	Rigid	2.0 mm	Gold ●	

## Screws

Self-retaining cruciform and starix connection between screw head and screwdriver shaft



Cruciform

Ø 1.2 mm Screws

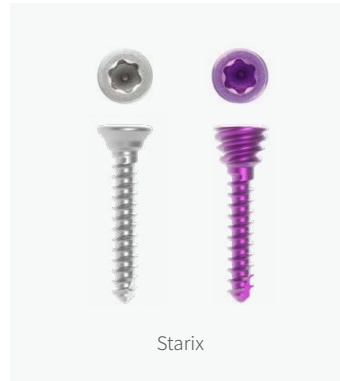

Starix

Ø 1.5 mm Screws

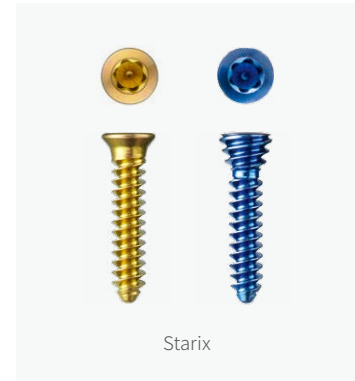

Starix

Ø 2.0 mm Screws

## Screw Variations

- Material: Titanium Alloy
- Locking & Non-locking variation available
- Variable locking system up to  $\pm 15^\circ$
- Diameter: Ø 1.2, Ø 1.5, Ø 2.0
- Length: 4 ~ 24 mm
- STARIX Pick-up for better torque transmission and less cam-out

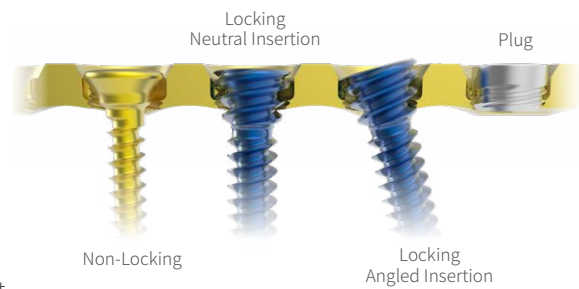

## Screw Specifications

Screw Types	Outer Diameter	Length	Insertion Types	Screw Head Recess	Color	Material
Cortical Screw (Non-Locking)	Ø 1.2 mm	4 ~ 16 mm	Self-Tapping	Cruciform	Gold ●	Titanium Alloy
	Ø 1.5 mm	6 ~ 24 mm	Self-Tapping	Starix	Silver ●	
	Ø 2.0 mm	6 ~ 24 mm	Self-Tapping	Starix	Gold ●	
Locking Screw	Ø 1.2 mm	4 ~ 16 mm	Self-Tapping	Cruciform	Blue ●	
	Ø 1.5 mm	6 ~ 24 mm	Self-Tapping	Starix	Purple ●	
	Ø 2.0 mm	6 ~ 24 mm	Self-Tapping	Starix	Blue ●	

## ARIX Vet System Plates

### Straight Plates



Z12-ST-024-F



Z12-ST-024-R



Z20-ST-024-M



Z20-ST-024-R

\* Illustrated scale 1:1

Code	Type	Width	Length	Holes	Thickness	Color	Set Quantity
Z12-ST-024-F	Flexible	3.0 mm	77.1 mm	24	1.4 mm	Blue	4
Z12-ST-024-R	Rigid	3.5 mm	77.6 mm	24	1.7 mm	Gold	4
Z20-ST-024-M	Middle	5.0 mm	121.0 mm	24	2.0 mm	Silver	4
Z20-ST-024-R	Rigid	6.0 mm	145.0 mm	24	2.2 mm	Gold	4

### Normal Straight Plates



Z12-ST-120-N



Z15-ST-124-N



Z20-ST-124-N

\* Illustrated scale 1:1

Code	Type	Width	Length	Holes	Thickness	Color	Set Quantity
Z12-ST-120-N	Rigid	4.0 mm	80.5 mm	20	1.7 mm	Gold	Optional
Z15-ST-124-N	Middle	5.0 mm	121.0 mm	24	2.0 mm	Silver	Optional
Z20-ST-124-N	Rigid	6.0 mm	145.0 mm	24	2.2 mm	Gold	Optional

## Reconstruction Plates



Z12-ST-120-F



Z12-ST-116-R



Z20-ST-116-M



Z20-ST-118-R

\* Illustrated scale 1:1

Code	Type	Width	Length	Holes	Thickness	Color	Set Quantity
Z12-ST-120-F	Flexible	3.5 mm	80.0 mm	20	1.4 mm	Blue	Optional
Z12-ST-116-R	Rigid	4.0 mm	79.5 mm	16	1.7 mm	Gold	Optional
Z20-ST-116-M	Middle	5.5 mm	111.5 mm	16	2.0 mm	Silver	Optional
Z20-ST-118-R	Rigid	6.5 mm	143.5 mm	18	2.2 mm	Gold	Optional

## T Plates



Z12-TT-029-F



Z12-TT-124-F



Z12-TT-029-R



Z12-TT-120-R



Z20-TT-012-R

\* Illustrated scale 1:1

Code	Type	Width	Length	Holes	Thickness	Color	Set Quantity
Z12-TT-029-F	Flexible	Head : 5.7 mm / Shaft : 3.0 mm	87.4 mm	29	1.4 mm	Blue	4
Z12-TT-029-R	Rigid	Head : 6.4 mm / Shaft : 4.0 mm	87.4 mm	29	1.7 mm	Gold	4
Z12-TT-124-F	Flexible	Head : 7.0 mm / Shaft : 3.5 mm	89.2 mm	24	1.4 mm	Blue	Optional
Z12-TT-120-R	Rigid	Head : 7.0 mm / Shaft : 4.0 mm	89.2 mm	20	1.7 mm	Gold	Optional
Z20-TT-012-R	Rigid	Head : 10.0 mm / Shaft : 4.5 mm	56.8 mm	12	2.0 mm	Gold	4

## ARIX Vet System Plates

### TPLO Plates (7 holes)



\* Illustrated scale 1:1

Code	Type	Width	Length	Holes	Thickness	Color	Set Quantity
Z20-TL-007-F	Flexible, Left	Head : 8.7 mm / Shaft : 4.3 mm	33.0 mm	7	2.0 mm	Blue	2
Z20-TL-007-R	Rigid, Left	Head : 10.8 mm / Shaft : 4.7 mm	36.0 mm	7	2.0 mm	Gold	2
Z20-TM-007-R	Rigid, Middle	Head : 9.0 mm / Shaft : 4.7 mm	35.0 mm	7	2.0 mm	Gold	2
Z20-TR-007-F	Flexible, Right	Head : 8.7 mm / Shaft : 4.3 mm	33.0 mm	7	2.0 mm	Blue	2
Z20-TR-007-R	Rigid, Right	Head : 10.8 mm / Shaft : 4.7 mm	36.0 mm	7	2.0 mm	Gold	2

### TPLO Plates (6 holes)



\* Illustrated scale 1:1

Code	Type	Width	Length	Holes	Thickness	Color	Set Quantity
Z20-TL-106-F	Flexible, Left	Head : 8.7 mm / Shaft : 5.0 mm	28.7 mm	6	2.0 mm	Blue	Optional
Z20-TL-106-R	Rigid, Left	Head : 10.8 mm / Shaft : 5.5 mm	31.5 mm	6	2.0 mm	Gold	Optional
Z20-TR-106-R	Rigid, Right	Head : 10.8 mm / Shaft : 5.5 mm	31.5 mm	6	2.0 mm	Gold	Optional
Z20-TR-106-F	Flexible, Right	Head : 8.7 mm / Shaft : 5.0 mm	28.7 mm	6	2.0 mm	Blue	Optional



CBLO Plates



\* Illustrated scale 1:1

Code	Type	Width	Length	Holes	Thickness	Color	Set Quantity
Z20-CL-006	Rigid, Left	Head : 15.9 mm / Shaft : 6.0 mm	34.8 mm	6	2.5 mm	Gold	Optional
Z20-CR-006	Rigid, Right	Head : 15.9 mm / Shaft : 6.0 mm	34.8 mm	6	2.5 mm	Gold	Optional

DFO Plates (9 holes / 7 holes)



\* Illustrated scale 1:1

Code	Type	Width	Length	Holes	Thickness	Color	Set Quantity
Z20-FL-009-F	Flexible, Left	Head : 11.5 mm / Shaft : 4.0 mm	38.9 mm	9	2.0 mm	Blue	2
Z20-FL-009-R	Rigid, Left	Head : 13.0 mm / Shaft : 5.5 mm	48.4 mm	9	2.0 mm	Gold	2
Z20-FL-107-F	Flexible, Left	Head : 11.9 mm / Shaft : 4.5 mm	38.9 mm	7	2.0 mm	Blue	Optional
Z20-FL-107-R	Rigid, Left	Head : 13.0 mm / Shaft : 5.5 mm	48.4 mm	7	2.0 mm	Gold	Optional
Z20-FR-009-F	Flexible, Right	Head : 11.5 mm / Shaft : 4.0 mm	38.9 mm	9	2.0 mm	Blue	2
Z20-FR-009-R	Rigid, Right	Head : 13.0 mm / Shaft : 5.5 mm	48.4 mm	9	2.0 mm	Gold	2
Z20-FR-107-F	Flexible, Right	Head : 11.9 mm / Shaft : 4.5 mm	38.9 mm	7	2.0 mm	Blue	Optional
Z20-FR-107-R	Rigid, Right	Head : 13.0 mm / Shaft : 5.5 mm	48.4 mm	7	2.0 mm	Gold	Optional

## ARIX Vet System Plates

### Acetabulum Plates

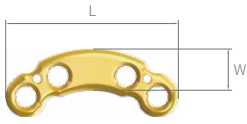

Z20-AC-004



Z20-AC-006

\* Illustrated scale 1:1

Code	Width	Length	Holes	Thickness	Color	Set Quantity
Z20-AC-004	5.5 mm	22.9 mm	4	2.0 mm	Gold	Optional
Z20-AC-006	5.5 mm	30.3 mm	6	2.0 mm	Gold	Optional

### Bridge Plates



Z20-BS-006-30



Z20-BS-006-40



Z20-BS-006-50

\* Illustrated scale 1:1

Code	Width	Length	Holes	Bridge Length	Thickness	Color	Set Quantity
Z20-BS-006-30	5.5 mm	60.5 mm	6	30 mm	2.0 mm	Gold	Optional
Z20-BS-006-40	5.5 mm	70.5 mm	6	40 mm	2.0 mm	Gold	Optional
Z20-BS-006-50	5.5 mm	80.5 mm	6	50 mm	2.0 mm	Gold	Optional



## ARIX Vet System Screws

### Ø 1.2 mm Cortical Screws



Code	Head Diameter	Outer Diameter	Length	Color	Set Quantity
Z12-SO-004	Ø 2.2 mm	Ø 1.2 mm	4 mm	Gold	5
Z12-SO-005	Ø 2.2 mm	Ø 1.2 mm	5 mm	Gold	5
Z12-SO-006	Ø 2.2 mm	Ø 1.2 mm	6 mm	Gold	5
Z12-SO-007	Ø 2.2 mm	Ø 1.2 mm	7 mm	Gold	5
Z12-SO-008	Ø 2.2 mm	Ø 1.2 mm	8 mm	Gold	5
Z12-SO-009	Ø 2.2 mm	Ø 1.2 mm	9 mm	Gold	5
Z12-SO-010	Ø 2.2 mm	Ø 1.2 mm	10 mm	Gold	5
Z12-SO-011	Ø 2.2 mm	Ø 1.2 mm	11 mm	Gold	5
Z12-SO-012	Ø 2.2 mm	Ø 1.2 mm	12 mm	Gold	5
Z12-SO-013	Ø 2.2 mm	Ø 1.2 mm	13 mm	Gold	5
Z12-SO-014	Ø 2.2 mm	Ø 1.2 mm	14 mm	Gold	5
Z12-SO-015	Ø 2.2 mm	Ø 1.2 mm	15 mm	Gold	5
Z12-SO-016	Ø 2.2 mm	Ø 1.2 mm	16 mm	Gold	5

### Ø 1.5 mm Cortical Screws



Code	Head Diameter	Outer Diameter	Length	Color	Set Quantity
Z15-SO-006	Ø 3.1 mm	Ø 1.5 mm	6 mm	Silver	5
Z15-SO-008	Ø 3.1 mm	Ø 1.5 mm	8 mm	Silver	5
Z15-SO-010	Ø 3.1 mm	Ø 1.5 mm	10 mm	Silver	5
Z15-SO-012	Ø 3.1 mm	Ø 1.5 mm	12 mm	Silver	5
Z15-SO-014	Ø 3.1 mm	Ø 1.5 mm	14 mm	Silver	5
Z15-SO-016	Ø 3.1 mm	Ø 1.5 mm	16 mm	Silver	5
Z15-SO-018	Ø 3.1 mm	Ø 1.5 mm	18 mm	Silver	5
Z15-SO-020	Ø 3.1 mm	Ø 1.5 mm	20 mm	Silver	5
Z15-SO-022	Ø 3.1 mm	Ø 1.5 mm	22 mm	Silver	Optional
Z15-SO-024	Ø 3.1 mm	Ø 1.5 mm	24 mm	Silver	Optional

### Ø 2.0 mm Cortical Screws



Code	Head Diameter	Outer Diameter	Length	Color	Set Quantity
Z20-SO-006	Ø 3.1 mm	Ø 2.0 mm	6 mm	Gold	5
Z20-SO-008	Ø 3.1 mm	Ø 2.0 mm	8 mm	Gold	5
Z20-SO-010	Ø 3.1 mm	Ø 2.0 mm	10 mm	Gold	5
Z20-SO-012	Ø 3.1 mm	Ø 2.0 mm	12 mm	Gold	5
Z20-SO-014	Ø 3.1 mm	Ø 2.0 mm	14 mm	Gold	5
Z20-SO-016	Ø 3.1 mm	Ø 2.0 mm	16 mm	Gold	5
Z20-SO-018	Ø 3.1 mm	Ø 2.0 mm	18 mm	Gold	5
Z20-SO-020	Ø 3.1 mm	Ø 2.0 mm	20 mm	Gold	5
Z20-SO-022	Ø 3.1 mm	Ø 2.0 mm	22 mm	Gold	Optional
Z20-SO-024	Ø 3.1 mm	Ø 2.0 mm	24 mm	Gold	Optional

## Ø 1.2 mm Locking Screws



Code	Head Diameter	Outer Diameter	Length	Color	Set Quantity
Z12L-SO-004	Ø 2.2 mm	Ø 1.2 mm	4 mm	Blue	5
Z12L-SO-005	Ø 2.2 mm	Ø 1.2 mm	5 mm	Blue	5
Z12L-SO-006	Ø 2.2 mm	Ø 1.2 mm	6 mm	Blue	5
Z12L-SO-007	Ø 2.2 mm	Ø 1.2 mm	7 mm	Blue	5
Z12L-SO-008	Ø 2.2 mm	Ø 1.2 mm	8 mm	Blue	5
Z12L-SO-009	Ø 2.2 mm	Ø 1.2 mm	9 mm	Blue	5
Z12L-SO-010	Ø 2.2 mm	Ø 1.2 mm	10 mm	Blue	5
Z12L-SO-011	Ø 2.2 mm	Ø 1.2 mm	11 mm	Blue	5
Z12L-SO-012	Ø 2.2 mm	Ø 1.2 mm	12 mm	Blue	5
Z12L-SO-013	Ø 2.2 mm	Ø 1.2 mm	13 mm	Blue	5
Z12L-SO-014	Ø 2.2 mm	Ø 1.2 mm	14 mm	Blue	5
Z12L-SO-015	Ø 2.2 mm	Ø 1.2 mm	15 mm	Blue	5
Z12L-SO-016	Ø 2.2 mm	Ø 1.2 mm	16 mm	Blue	5

## Ø 1.5 mm Locking Screws



Code	Head Diameter	Outer Diameter	Length	Color	Set Quantity
Z15L-SO-006	Ø 3.1 mm	Ø 1.5 mm	6 mm	Purple	5
Z15L-SO-008	Ø 3.1 mm	Ø 1.5 mm	8 mm	Purple	5
Z15L-SO-010	Ø 3.1 mm	Ø 1.5 mm	10 mm	Purple	5
Z15L-SO-012	Ø 3.1 mm	Ø 1.5 mm	12 mm	Purple	5
Z15L-SO-014	Ø 3.1 mm	Ø 1.5 mm	14 mm	Purple	5
Z15L-SO-016	Ø 3.1 mm	Ø 1.5 mm	16 mm	Purple	5
Z15L-SO-018	Ø 3.1 mm	Ø 1.5 mm	18 mm	Purple	5
Z15L-SO-020	Ø 3.1 mm	Ø 1.5 mm	20 mm	Purple	5
Z15L-SO-022	Ø 3.1 mm	Ø 1.5 mm	22 mm	Purple	Optional
Z15L-SO-024	Ø 3.1 mm	Ø 1.5 mm	24 mm	Purple	Optional

## Ø 2.0 mm Locking Screws



Code	Head Diameter	Outer Diameter	Length	Color	Set Quantity
Z20L-SO-006	Ø 3.1 mm	Ø 2.0 mm	6 mm	Blue	5
Z20L-SO-008	Ø 3.1 mm	Ø 2.0 mm	8 mm	Blue	5
Z20L-SO-010	Ø 3.1 mm	Ø 2.0 mm	10 mm	Blue	5
Z20L-SO-012	Ø 3.1 mm	Ø 2.0 mm	12 mm	Blue	5
Z20L-SO-014	Ø 3.1 mm	Ø 2.0 mm	14 mm	Blue	5
Z20L-SO-016	Ø 3.1 mm	Ø 2.0 mm	16 mm	Blue	5
Z20L-SO-018	Ø 3.1 mm	Ø 2.0 mm	18 mm	Blue	5
Z20L-SO-020	Ø 3.1 mm	Ø 2.0 mm	20 mm	Blue	5
Z20L-SO-022	Ø 3.1 mm	Ø 2.0 mm	22 mm	Blue	Optional
Z20L-SO-024	Ø 3.1 mm	Ø 2.0 mm	24 mm	Blue	Optional

## Instruments

### Drill Guide



Z111-187



Z111-185



Z111-186

Code	Description	Set Quantity
Z111-187	Drill Guide for Ø 1.2 mm Screws	1
Z111-185	Drill Guide for Ø 1.5 mm Screws	1
Z111-186	Drill Guide for Ø 2.0 mm Screws	1

### Plug Screw

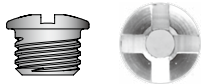

Z111-194



Z111-195

Code	Description	Set Quantity
Z111-194	Plug Screw for Ø 1.2 mm Screws (Head Diameter: Ø 2.4 mm, Length: 1.8 mm)	10
Z111-195	Plug Screw for Ø 1.5 / Ø 2.0 mm Screws (Head Diameter: Ø 3.3 mm, Length: 1.8 mm)	10

### Drill Bits (AO Type)

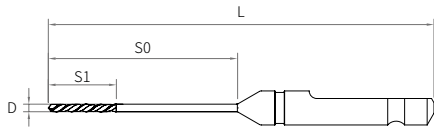

Code	Length	S0	S1	D	Set Quantity
Z112-12-701	69.0 mm	43.0 mm	20.0 mm	1.0 mm	1
Z112-15-702	93.0 mm	67.0 mm	20.0 mm	1.2 mm	1
Z112-20-701	93.0 mm	67.0 mm	20.0 mm	1.6 mm	1
Z112-15-701	74.0 mm	48.0 mm	20.0 mm	1.2 mm	Optional
Z112-20-702	66.0 mm	40.0 mm	20.0 mm	1.6 mm	Optional

### Drill Bits (Ball Type-Smarto Use)

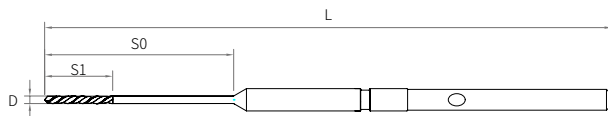

Code	Length	S0	S1	D	Set Quantity	Remark
Z112-12-801	93.0 mm	43.0 mm	10.0 mm	1.0 mm	Optional	
Z112-15-801	98.0 mm	48.0 mm	10.0 mm	1.2 mm	Optional	111-ED-050
Z112-20-801	98.0 mm	48.0 mm	10.0 mm	1.6 mm	Optional	

### Screwdriver Shaft



Z113-NF-101



Z113-ST-001

Code	Description	Set Quantity
Z113-NF-101	Screwdriver Shaft for Ø 1.2 mm Screws (Cruciform)	2
Z113-ST-001	Screwdriver Shaft for Ø 1.5 / Ø 2.0 mm Screws (STARIX Driver)	2

## Instruments

### Drill Sleeve



Z111-182 / Z111-183 / Z111-210



Z111-184 / Z111-160F



Z111-157

Code	Description	Set Quantity
Z111-182	Drill Sleeve for Ø 1.2 mm Screws, Fixed Angle	1
Z111-183	Drill Sleeve for Ø 1.5 mm Screws, Fixed Angle	1
Z111-210	Drill Sleeve for Ø 2.0 mm Screws, Fixed Angle	1
Z111-184	Drill Sleeve for Ø 1.5 mm Screws, Variable Angle	1
Z111-160F	Drill Sleeve for Ø 2.0 mm Screws, Variable Angle	1
Z111-157	Drill Sleeve Handle for Ø 1.5 / Ø 2.0 mm Screws, Variable Angle	2

### Depth Gauge



Code	Description	Set Quantity
Z111-010	Screwdriver Handle	2

### Forceps



Code	Description	Set Quantity
Z114-009	Grasping Forceps	1

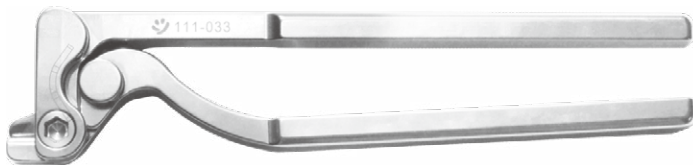

Plate Cutter



Code	Description	Set Quantity
Z111-190	Plate Cutter	1

Plate Bender



Z111-033



Z111-191

Code	Description	Set Quantity
Z111-033	Plate Bender (Plier Type)	Optional
Z111-191	Plate Bender (Bar Type - Used as a pair)	2

## Instruments

### Screw Disk

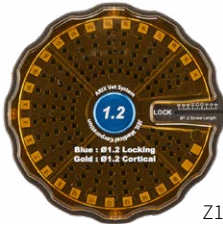

Z112-125-1

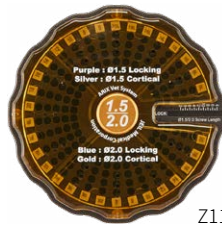

Z112-125-2

Code	Description	Set Quantity
Z112-125-1	Screw Disk for Ø 1.2 mm Screws * Without Implants	Optional
Z112-125-2	Screw Disk for Ø 1.5 / Ø 2.0 mm Screws * Without Implants	Optional

### Module

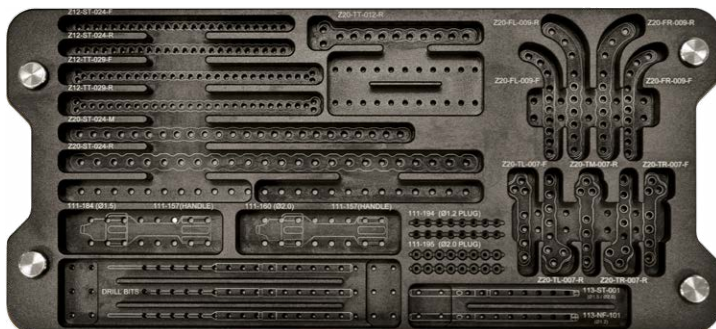

Code	Description	Set Quantity
Z112-125-3	ARIX Vet Plate Module * Without Implants	Optional

### Screwdriver Handle



Z111-188R



Z111-189R

Code	Description	Set Quantity
Z111-188R	Depth Gauge for Ø 1.2 mm Screws	1
Z111-189R	Depth Gauge for Ø 1.5 / Ø 2.0 mm Screws	1

### Kit



Z112-125

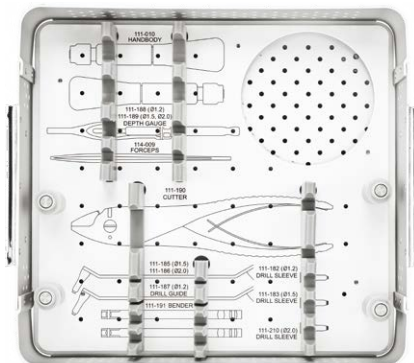

Z112-125-4

Code	Description	Set Quantity
Z112-125	ARX Vet 1.2 / 1.5 / 2.0 mm System Full Kit	1
Z112-125-4	ARX Vet System Container * Without Implants	Optional

## Instruments

### Smarto

Single use disposable design eliminates need for autoclaving and repairing



Code	Torque (N.cm ±10%)	RPM (±10%)	Shaft Diameter	Set Quantity
111-ED-050	45	210	Ø 3.0 mm	Optional

### K-wire Dispenser

Only Steam Sterilization (132°C, 15min)



Code	Description	Set Quantity
Z111-096-V	ARIX Vet System K-wire Dispenser (Ø 0.6 / Ø 0.7 / Ø 0.8 / Ø 0.9 / Ø 1.0 / Ø 1.1 / Ø 1.2 / Ø 1.4 / Ø 1.6) * Without K-wire	Optional



Straight Plates					
No.	Code	Description			Q'ty
1	Z12-ST-024-F	24 holes	Flexible, Straight	Ø 1.2	4
2	Z12-ST-024-R	24 holes	Rigid, Straight	Ø 1.2	4
3	Z20-ST-024-M	24 holes	Middle, Straight	Ø 1.5 / Ø 2.0	4
4	Z20-ST-024-R	24 holes	Rigid, Straight	Ø 1.5 / Ø 2.0	4

T Plates					
No.	Code	Description			Q'ty
1	Z12-TT-029-F	29 holes	Flexible, T	Ø 1.2	4
2	Z12-TT-029-R	29 holes	Rigid, T	Ø 1.2	4
3	Z20-TT-012-R	12 holes	Rigid, T	Ø 1.5 / Ø 2.0	4

Normal Straight Plates					
No.	Code	Description			Q'ty
1	Z12-ST-120-N	20 holes	Normal	Ø 1.2	Optional
2	Z15-ST-124-N	24 holes	Normal	Ø 1.5 / Ø 2.0	Optional
3	Z20-ST-124-N	24 holes	Normal	Ø 1.5 / Ø 2.0	Optional

Reconstruction Plates					
No.	Code	Description			Q'ty
1	Z12-ST-120-F	20 holes	Flexible, Straight	Ø 1.2	Optional
2	Z12-TT-124-F	24 holes	Flexible, T	Ø 1.2	Optional
3	Z12-ST-116-R	16 holes	Rigid, Straight	Ø 1.2	Optional
4	Z12-TT-120-R	20 holes	Rigid, T	Ø 1.2	Optional
5	Z20-ST-116-M	16 holes	Middle, Straight	Ø 1.5 / Ø 2.0	Optional
6	Z20-ST-118-R	18 holes	Rigid, Straight	Ø 1.5 / Ø 2.0	Optional

TPLO Plates					
No.	Code	Description			Q'ty
1	Z20-TL-007-F	7 holes	Flexible, Left	Ø 1.5 / Ø 2.0	2
2	Z20-TL-007-R	7 holes	Rigid, Left	Ø 1.5 / Ø 2.0	2
3	Z20-TM-007-R	7 holes	Rigid, Middle	Ø 1.5 / Ø 2.0	2
4	Z20-TR-007-F	7 holes	Flexible, Right	Ø 1.5 / Ø 2.0	2
5	Z20-TR-007-R	7 holes	Rigid, Right	Ø 1.5 / Ø 2.0	2
6	Z20-TL-106-F	6 holes	Flexible, Left	Ø 1.5 / Ø 2.0	Optional
7	Z20-TL-106-R	6 holes	Rigid, Left	Ø 1.5 / Ø 2.0	Optional
8	Z20-TR-106-R	6 holes	Rigid, Right	Ø 1.5 / Ø 2.0	Optional
9	Z20-TR-106-F	6 holes	Flexible, Right	Ø 1.5 / Ø 2.0	Optional

DFO Plates					
No.	Code	Description			Q'ty
1	Z20-FL-009-F	9 holes	Flexible, Left	Ø 1.5 / Ø 2.0	2
2	Z20-FL-009-R	9 holes	Rigid, Left	Ø 1.5 / Ø 2.0	2
3	Z20-FR-009-F	9 holes	Rigid, Right	Ø 1.5 / Ø 2.0	2
4	Z20-FR-009-R	9 holes	Flexible, Right	Ø 1.5 / Ø 2.0	2
5	Z20-FL-107-F	7 holes	Flexible, Left	Ø 1.5 / Ø 2.0	Optional
6	Z20-FL-107-R	7 holes	Rigid, Left	Ø 1.5 / Ø 2.0	Optional
7	Z20-FR-009-F	7 holes	Flexible, Right	Ø 1.5 / Ø 2.0	Optional
8	Z20-FR-009-R	7 holes	Rigid, Right	Ø 1.5 / Ø 2.0	Optional

CBLO Plates					
No.	Code	Description			Q'ty
1	Z20-CL-006	6 holes	Rigid, Left	Ø 2.0	Optional
2	Z20-CR-006	6 holes	Rigid, Right	Ø 2.0	Optional

Acetabulum / Bridge Plates					
No.	Code	Description			Q'ty
1	Z20-AC-004	4 holes	Acetabulum	Ø 2.0	Optional
2	Z20-AC-006	6 holes	Acetabulum	Ø 2.0	Optional
3	Z20-BS-006-30	6 holes	Bridge Plate	Ø 2.0	Optional
4	Z20-BS-006-40	6 holes	Bridge Plate	Ø 2.0	Optional
5	Z20-BS-006-50	6 holes	Bridge Plate	Ø 2.0	Optional

Ø 1.2 mm Screws				
No.	Code	Description		Q'ty
1	Z12-SO-004	Ø 1.2 mm Cortical Screw, Length 4 mm		5
2	Z12-SO-005	Ø 1.2 mm Cortical Screw, Length 5 mm		5
3	Z12-SO-006	Ø 1.2 mm Cortical Screw, Length 6 mm		5
4	Z12-SO-007	Ø 1.2 mm Cortical Screw, Length 7 mm		5
5	Z12-SO-008	Ø 1.2 mm Cortical Screw, Length 8 mm		5
6	Z12-SO-009	Ø 1.2 mm Cortical Screw, Length 9 mm		5
7	Z12-SO-010	Ø 1.2 mm Cortical Screw, Length 10 mm		5
8	Z12-SO-011	Ø 1.2 mm Cortical Screw, Length 11 mm		5
9	Z12-SO-012	Ø 1.2 mm Cortical Screw, Length 12 mm		5
10	Z12-SO-013	Ø 1.2 mm Cortical Screw, Length 13 mm		5
11	Z12-SO-014	Ø 1.2 mm Cortical Screw, Length 14 mm		5
12	Z12-SO-015	Ø 1.2 mm Cortical Screw, Length 15 mm		5
13	Z12-SO-016	Ø 1.2 mm Cortical Screw, Length 16 mm		5
14	Z12L-SO-004	Ø 1.2 mm Locking Screw, Length 4 mm		5
15	Z12L-SO-005	Ø 1.2 mm Locking Screw, Length 5 mm		5
16	Z12L-SO-006	Ø 1.2 mm Locking Screw, Length 6 mm		5
17	Z12L-SO-007	Ø 1.2 mm Locking Screw, Length 7 mm		5
18	Z12L-SO-008	Ø 1.2 mm Locking Screw, Length 8 mm		5
19	Z12L-SO-009	Ø 1.2 mm Locking Screw, Length 9 mm		5
20	Z12L-SO-010	Ø 1.2 mm Locking Screw, Length 10 mm		5
21	Z12L-SO-011	Ø 1.2 mm Locking Screw, Length 11 mm		5
22	Z12L-SO-012	Ø 1.2 mm Locking Screw, Length 12 mm		5
23	Z12L-SO-013	Ø 1.2 mm Locking Screw, Length 13 mm		5
24	Z12L-SO-014	Ø 1.2 mm Locking Screw, Length 14 mm		5
25	Z12L-SO-015	Ø 1.2 mm Locking Screw, Length 15 mm		5
26	Z12L-SO-016	Ø 1.2 mm Locking Screw, Length 16 mm		5

Ø 1.5 mm Screws				
No.	Code	Description		Q'ty
1	Z15-SO-006	Ø 1.5 mm Cortical Screw, Length 6 mm		5
2	Z15-SO-008	Ø 1.5 mm Cortical Screw, Length 8 mm		5
3	Z15-SO-010	Ø 1.5 mm Cortical Screw, Length 10 mm		5
4	Z15-SO-012	Ø 1.5 mm Cortical Screw, Length 12 mm		5
5	Z15-SO-014	Ø 1.5 mm Cortical Screw, Length 14 mm		5
6	Z15-SO-016	Ø 1.5 mm Cortical Screw, Length 16 mm		5
7	Z15-SO-018	Ø 1.5 mm Cortical Screw, Length 18 mm		5
8	Z15-SO-020	Ø 1.5 mm Cortical Screw, Length 20 mm		5
9	Z15-SO-022	Ø 1.5 mm Cortical Screw, Length 22 mm		Optional
10	Z15-SO-024	Ø 1.5 mm Cortical Screw, Length 24 mm		Optional
11	Z15L-SO-006	Ø 1.5 mm Locking Screw, Length 6 mm		5
12	Z15L-SO-008	Ø 1.5 mm Locking Screw, Length 8 mm		5
13	Z15L-SO-010	Ø 1.5 mm Locking Screw, Length 10 mm		5
14	Z15L-SO-012	Ø 1.5 mm Locking Screw, Length 12 mm		5
15	Z15L-SO-014	Ø 1.5 mm Locking Screw, Length 14 mm		5
16	Z15L-SO-016	Ø 1.5 mm Locking Screw, Length 16 mm		5
17	Z15L-SO-018	Ø 1.5 mm Locking Screw, Length 18 mm		5
18	Z15L-SO-020	Ø 1.5 mm Locking Screw, Length 20 mm		5
19	Z15L-SO-022	Ø 1.5 mm Locking Screw, Length 22 mm		Optional
20	Z15L-SO-024	Ø 1.5 mm Locking Screw, Length 24 mm		Optional

Ø 2.0 mm Screws				Instruments			
No.	Code	Description	Q'ty	No.	Code	Description	Q'ty
1	Z20-SO-006	Ø 2.0 mm Cortical Screw, Length 6 mm	5	1	Z113-NF-101	Screw Driver Shaft	Ø 1.2 2
2	Z20-SO-008	Ø 2.0 mm Cortical Screw, Length 8 mm	5	2	Z113-ST-001	Screw Driver Shaft	Ø 1.5 / Ø 2.0 2
3	Z20-SO-010	Ø 2.0 mm Cortical Screw, Length 10 mm	5	3	Z112-12-701	Drill Bit, AO Type	Ø 1.2 1
4	Z20-SO-012	Ø 2.0 mm Cortical Screw, Length 12 mm	5	4	Z112-15-702	Drill Bit, AO Type	Ø 1.5 1
5	Z20-SO-014	Ø 2.0 mm Cortical Screw, Length 14 mm	5	5	Z112-20-701	Drill Bit, AO Type	Ø 2.0 1
6	Z20-SO-016	Ø 2.0 mm Cortical Screw, Length 16 mm	5	6	Z112-15-701	Drill Bit, AO Type	Ø 1.5 Optional
7	Z20-SO-018	Ø 2.0 mm Cortical Screw, Length 18 mm	5	7	Z112-20-702	Drill Bit, AO Type	Ø 2.0 Optional
8	Z20-SO-020	Ø 2.0 mm Cortical Screw, Length 20 mm	5	8	Z112-12-801	Drill Bit, Ball Type	Ø 1.2 Optional
9	Z20-SO-022	Ø 2.0 mm Cortical Screw, Length 22 mm	Optional	9	Z112-15-801	Drill Bit, Ball Type	Ø 1.5 Optional
10	Z20-SO-024	Ø 2.0 mm Cortical Screw, Length 24 mm	Optional	10	Z112-20-801	Drill Bit, Ball Type	Ø 2.0 Optional
11	Z20L-SO-006	Ø 2.0 mm Locking Screw, Length 6 mm	5	11	Z114-009	Forceps	Ø 1.2 / Ø 1.5 / Ø 2.0 1
12	Z20L-SO-008	Ø 2.0 mm Locking Screw, Length 8 mm	5	12	Z111-010	Screw Driver Handle	Ø 1.2 / Ø 1.5 / Ø 2.0 2
13	Z20L-SO-010	Ø 2.0 mm Locking Screw, Length 10 mm	5	13	Z111-187	Drill Guide	Ø 1.2 1
14	Z20L-SO-012	Ø 2.0 mm Locking Screw, Length 12 mm	5	14	Z111-185	Drill Guide	Ø 1.5 1
15	Z20L-SO-014	Ø 2.0 mm Locking Screw, Length 14 mm	5	15	Z111-186	Drill Guide	Ø 2.0 1
16	Z20L-SO-016	Ø 2.0 mm Locking Screw, Length 16 mm	5	16	Z111-194	Plug	Ø 1.2 10
17	Z20L-SO-018	Ø 2.0 mm Locking Screw, Length 18 mm	5	17	Z111-195	Plug	Ø 1.5 / Ø 2.0 10
18	Z20L-SO-020	Ø 2.0 mm Locking Screw, Length 20 mm	5	18	Z111-182	Drill Sleeve, Fixed Angle	Ø 1.2 1
19	Z20L-SO-022	Ø 2.0 mm Locking Screw, Length 22 mm	Optional	19	Z111-183	Drill Sleeve, Fixed Angle	Ø 1.5 1
20	Z20L-SO-024	Ø 2.0 mm Locking Screw, Length 24 mm	Optional	20	Z111-210	Drill Sleeve, Fixed Angle	Ø 2.0 1
				21	Z111-184	Drill Sleeve, Variable Angle	Ø 1.5 1
				22	Z111-160F	Drill Sleeve, Variable Angle	Ø 2.0 1
				23	Z111-157	Drill Sleeve Handle, Variable Angle	Ø 1.5 / Ø 2.0 2
				24	Z111-188R	Depth Gauge	Ø 1.2 1
				25	Z111-189R	Depth Gauge	Ø 1.5 / Ø 2.0 1
				26	Z111-033	Plate Bender	Ø 1.2 / Ø 1.5 / Ø 2.0 Optional
				27	Z111-191	Plate Bender	Ø 1.2 / Ø 1.5 / Ø 2.0 2
				28	Z111-190	Plate Cutter	Ø 1.2 / Ø 1.5 / Ø 2.0 1
				29	111-ED-050	Smarto	Ø 1.2 / Ø 1.5 / Ø 2.0 Optional
				30	Z112-125	ARIX Vet System Tray	- 1
				31	Z112-125-1	Screw Disk	Ø 1.2 Optional
				32	Z112-125-2	Screw Disk	Ø 1.5 / Ø 2.0 Optional
				33	Z112-125-3	ARIX Vet Plate Module	Ø 1.2 / Ø 1.5 / Ø 2.0 Optional
				34	Z112-125-4	ARIX Vet System Container	- Optional

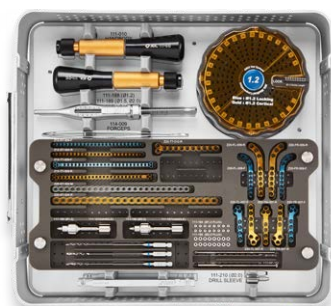

Z112-125  
ARIX Vet 1.2 / 1.5 / 2.0 System

**JEILMEDICAL**

**JEILMEDICAL CORPORATION**

702·703·704·705·706·804·805·807·812·815-ho, 55, Digital-ro 34-gil, Guro-gu, Seoul, 08378, Rep. of Korea

**DOMESTIC SALES** T 82.2.850.3500 F 82.2.850.3535 E jeil@jeilmed.co.kr

**INTERNATIONAL SALES** T 82.2.850.3898 F 82.2.850.3537 E global@jeilmed.co.kr

[www.jeilmed.co.kr](http://www.jeilmed.co.kr) [www.arixvet.com](http://www.arixvet.com)

Print Date: 2021-09-17 41-A01(04)